

Carvey – Clamping Material into Position

Step 1: Move the Smart Clamp aside

- Move the upper piece of the Smart Clamp out of the way to enable you to position your material properly.



Step 2: Position the material

- Place the material snugly against the two stops of the Smart Clamp, in the lower left-hand corner of the waste board.
- Line the lower edge of your material up with the black line



Step 3: Find the proper size screws for your material

- As part of the carving prompts, Easel will tell you which size screws to use based on the thickness of your material.
- In this example, Easel recommends blue screws.



Step 4: Screw down the Smart Clamp

- Using two of the proper-size screws, Screw the upper piece of the Smart Clamp firmly in place.
- It is usually best not to tighten one screw all the way before inserting the other. To get a good, tight clamp, it is better to tighten both screws down together.

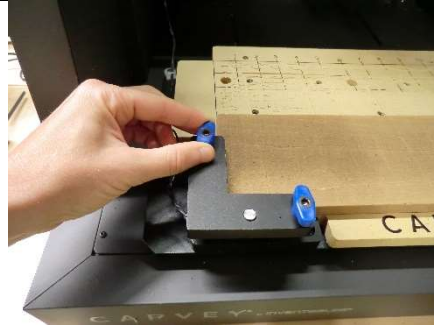

Step 5: Determine positions of the remaining clamps

- Double-check your design in Easel to find places where clamps can be placed without being accidentally cut as part of the design.
- Clamps can be placed anywhere on the waste board that there is a screw hole (indicated in the picture).
- Try to distribute the clamps fairly evenly around your material.



Step 6: Collect the materials for each clamp

- Each clamp uses a screw (the same color as was used for the Smart Clamp), a step-block, and a bridge.
- Step-blocks come in two different heights, and bridges come in a number of different lengths. Find the combination that works for the clamping location you have in mind.

**Step 7: Start the screw**

- Slide the screw through the slot on the bridge, and twist the screw into its hole a few turns.

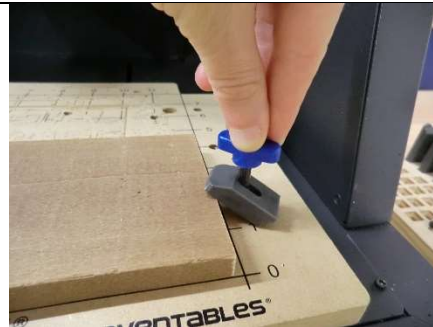
**Step 8: Position the step-block**

- With the flat side of the step-block down, place it behind the clamp.
- Mate the teeth on the bridge with the teeth on the step-block so that the bridge is level with the surface of the material, rather than at an angle.
- The first picture shows a properly positioned clamp, the second shows the step-block in the wrong orientation and the bridge at an angle rather than flat.

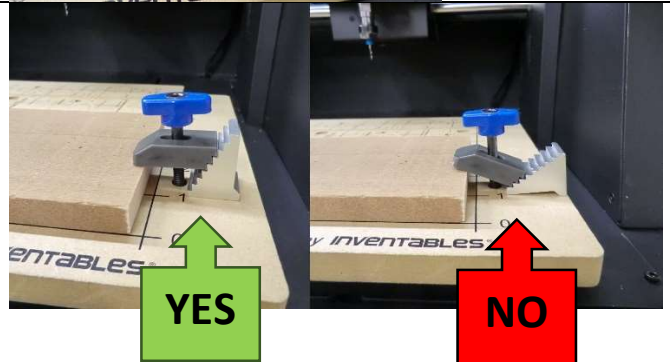
**Step 9: Tighten the screw**

- Tighten the screw down to hold the clamp firmly into place.

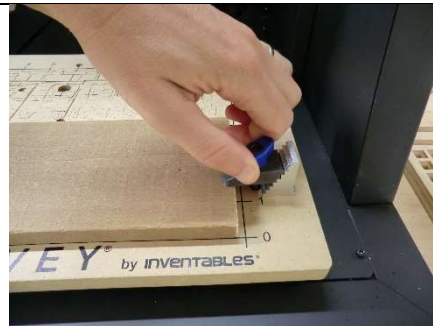
**Step 10: Repeat with two other clamps**

- Follow steps 6-9 to position and tighten the other two clamps.
- Clamps can be rotated to the angles needed to keep the clamp out of the path of the cutting head.
- When all the clamps are positioned, check one last time that none of them are in the path of your design.

