

Silhouette Cameo – Changing Blade Depth

Step 1: Locate the suggested blade depth

- On a laptop, go to the “Send” tab in Silhouette Studio.
- On the right-hand side of the screen, select your material from the “Material” drop-down menu.
- With the material selected, the blade depth icon will display the number to set the Silhouette blade to.
- In the example in the picture, the blade depth is 3.



Step 2: Remove the blade unit

- Lift the lid of the Silhouette.
- Turn the white knob counterclockwise to release the blade.
- Lift the black blade unit out of its white housing.



Step 3: Insert the blade unit into the adjustment socket

- The red dot on the blade indicates the current blade setting. In the example, the blade is set to 1.
- Insert the blade into the adjustment socket on the Silhouette such that the number indicated by the red dot is aligned with the black arrow on the Silhouette.



Step 4: Turn the blade to the correct depth setting

- Turn the blade unit until the black arrow aligns with the desired blade setting, in this case, 3.
- Remove the blade unit from the adjustment socket. The red dot should now be indicating the number 3.

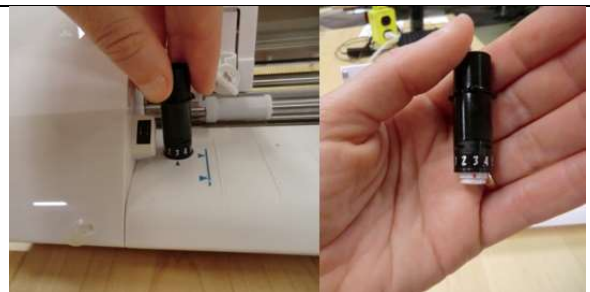

Step 5: Re-insert and lock the blade unit

- Slide the black blade unit back into the white housing, until the collar on the blade unit rests against the housing.
- Turn the white knob clockwise to lock the blade unit into place.

